

Hingham Public Library

Monday - Thursday 10am-9pm
 Saturdays 9am-5pm
 Sundays 1pm-5pm (October - April)
 Fridays Closed

Reference
 Renewals/General Information
 Library Administration
 Children & Teens
 email: hiref@ocln.org

781.741.1405 x 2608
 781.741.1405 x 2618
 781.741.1405 x 2600
 781.741.1405 x 2613
 www.hinghamlibrary.org

Lower Level

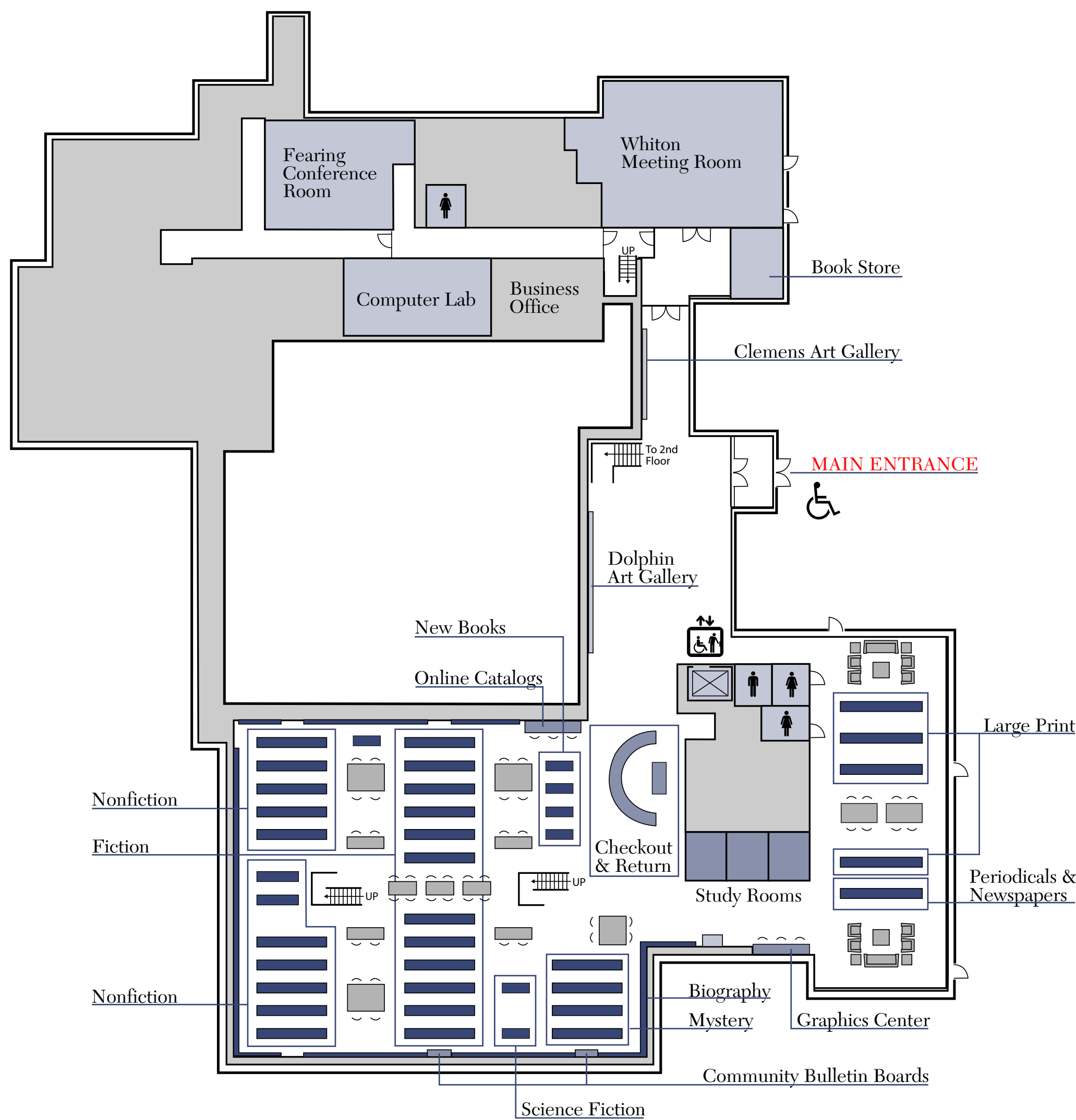

- Adult Collection**
 - New Books
 - Biography
 - Fiction
 - Mystery
 - Science Fiction
 - Nonfiction 000-599
 - Large Print
 - Periodicals & Newspapers

- Checkout/Return Desk**
- Online Catalogs
- Study Rooms
- Graphics Center
- Community Bulletin Boards

- Bookstore**
- Elevator
- Clemens Art Gallery
- Dolphin Art Gallery
- Computer Lab
- Fearing Conference Room
- Whiton Meeting Room

- Business Office**
- Staff Space

Upper Level

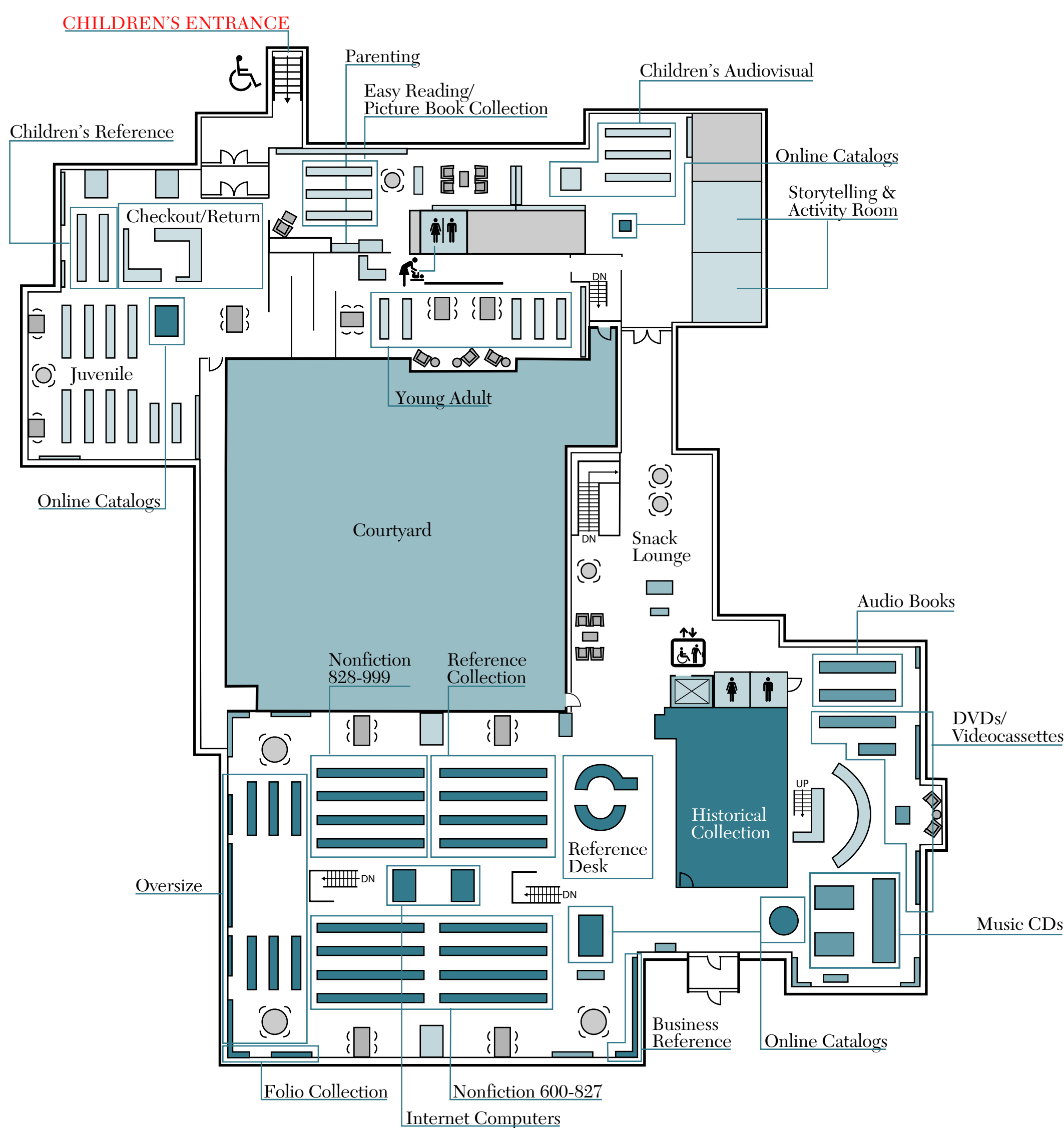

- Reference Area**
 - Reference & Reader Services Desk
 - Reference Collection
 - Business Reference Collection
 - Online Catalogs
 - Internet Computers
 - Historical Collection
 - Nonfiction 600-827
 - Nonfiction 828-999
 - Oversize Collection
 - Folio Collection

- Audiovisual Area**
 - Music CDs
 - Videos
 - Audiobooks

- "Commons" Area**
 - Courtyard
 - Elevator
 - Snack Lounge

- Children's/YA Area**
 - Activity/Storytelling Room
 - Children's Audiovisual
 - Young Adult Collection
 - Parenting Collection
 - Easy Reading/Picture Book Collection
 - Juvenile Collection
 - Juvenile Reference
 - Children's Checkout/Return Desk

hours

directory lower level

directory upper level